

SECTION A-A

Circular knives are heat treated, to a hardness specified by customer requirements, up to 63 R/C.

This knife is typically made from A2. Other materials are also available for quote.

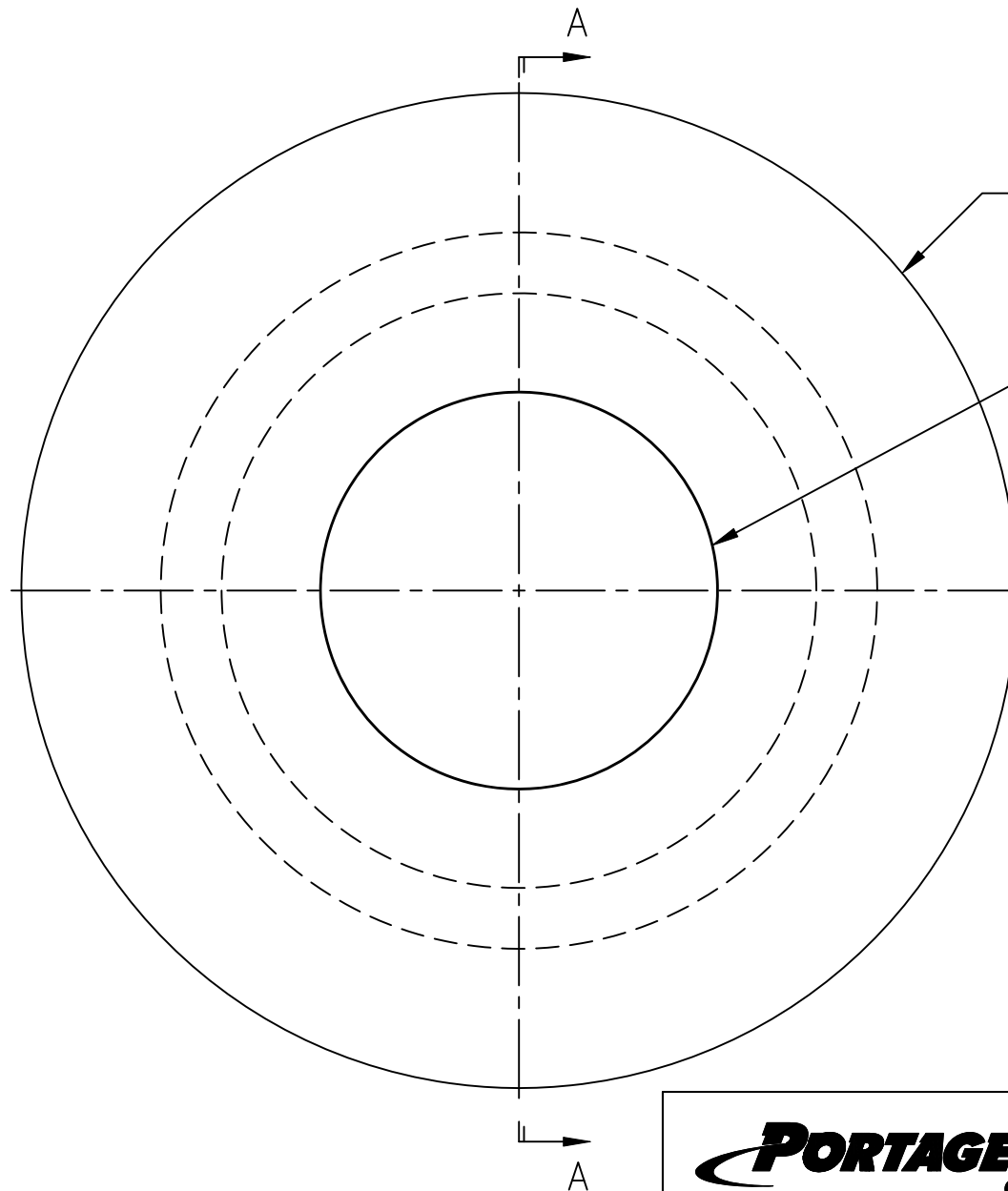

Cutting edge has an .008" flat. Other edges available for quote.

ID tolerance per customer requirements.

WEB PRINT

PORTAGE KNIFE COMPANY MANUFACTURER OF SCORE SLITTERS AND PERFORATORS
A DIVISION OF PORTAGE MACHINE CONCEPTS, INC. AKRON, OHIO (330) 784-0700

494-10-008 Flat Circular Knife

SIZE A	DWG NAME: W494-10-008Flat.dwg
-----------	----------------------------------

SCALE: NONE	DATE: 7/27/2018	DRAWN: D. MILLER	SHEET: 1 OF 1
-------------	-----------------	------------------	---------------