

MINIMAL
HOLDER
CLEARANCE
(RELIEF)

0.244

0.866 ϕ

1.75 ϕ
HUB

3.030 ϕ

R0.003
TYP

SECTION A-A

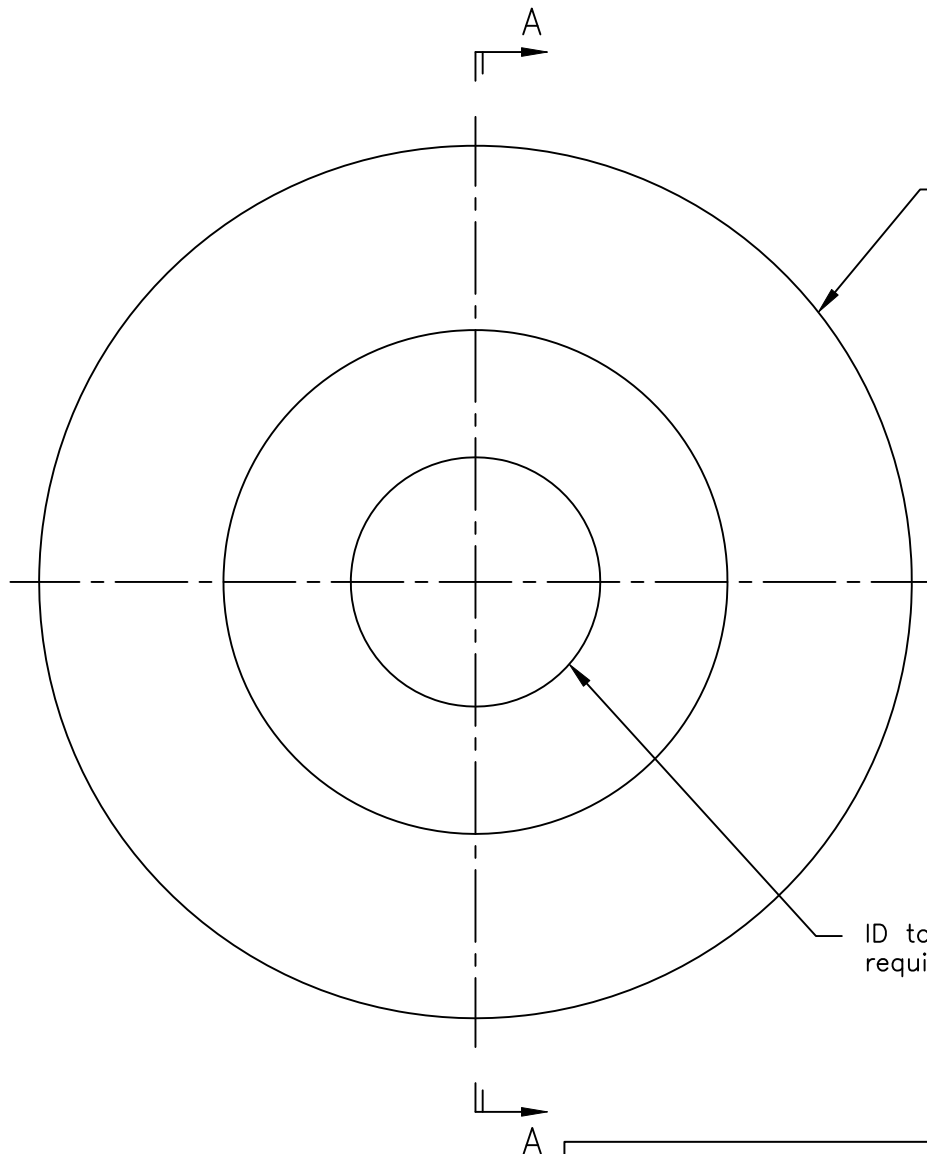

Creaser Blade—
Outer edges have a radius
to prevent blade from
cutting into material.

ID tolerance per customer
requirements.

WEB PRINT

Circular knives are manufactured from 52100 steel
and heat treated to a hardness of 61–63 R/C.

Other materials are also available for quote.

PORTAGE KNIFE
COMPANY

MANUFACTURER OF
SCORE SLITTERS
AND PERFORATORS

A DIVISION OF PORTAGE MACHINE CONCEPTS, INC. AKRON, OHIO (330) 784-0700

300-00-003-.234

SIZE
A

DWG NAME:

W300-00-003-234.dwg

SCALE:

NONE

DATE: 8/24/2017

DRAWN: D. MILLER

SHEET: 1 OF 1

This print and the intellectual content is the property of Portage Machine Concepts, Inc. and must not be copied,
transmitted or disseminated, in any way, without the written permission of Portage Machine Concepts, Inc.